

WARNING!!

READ THIS MANUAL BEFORE OPERATING TOOL

Buildex[®]

AutoTek[®]
MULTI FEED 
Metal Roof Fastening System

*Operator's Manual and
Maintenance Instructions*



*AutoTek[®] Multi Feed Tool Assembly
Part Number: 6-991-0401-1*

CONTENTS

Safety Precautions	3, 4
Operation	5
Fastener Selection Guidelines	6
Dismantling Front Section.....	7
Reassembly of front section	8
Parts Assembly.....	9
Troubleshooting Guidelines	10
Warranty.....	11

Warning!!

When using electric tools, safety precautions should always be followed to reduce the risk of fire, electric shock and personal injury. Failure to follow these instructions can result in severe personal injury.

READ ALL INSTRUCTIONS BEFORE OPERATING THE TOOL.

General Safety Considerations

1. Before using the tool, become familiar with all operating instructions.
2. Don't use tool for purposes not intended, for example: don't use tool as a hammer.
3. Failure to wear safety glasses with side shields can result in severe eye injury or blindness. Always wear safety glasses with side shields.
4. Keep work area clean and well lit. Dark, cluttered work areas and benches invite injury.
5. Dress properly! Never operate tool while wearing loose clothing or jewelry. They can be caught in moving parts.
6. Maintain proper footing and balance at all times:
 - Do not use tool when you are in an awkward position.
 - Don't overreach with tool.
7. **STAY ALERT!!** Know what you are doing. Use common sense. Do not operate tool when you are tired.

SAFETY PRECAUTIONS

Safety Procedures for Electric Tools

1. Guard against electric shock.
2. Consider work environment:
 - Never operate tool in damp or wet locations.
 - Prevent body contact with grounded surfaces, such as pipes.
 - Use only extension cords intended for use outdoors and so marked.
 - Wear gloves and non-skid foot wear when working outdoors .
 - Don't expose power tools in rain.
 - Never operate tool in the presence of flammable liquids or gases.
3. Never allow visitors to contact tool or extension cords. All visitors should be deep away from work area.
4. DON'T ABUSE TOOL:
 - Keep handle dry, clean and free from oil and grease.
 - Never carry tool by cord or yank it to disconnect from receptacle.
 - Always keep cord from heat, oil and sharp edges.
 - Always store idle tool in dry, high or locked up place.
 - Always disconnect tool when not in use or before servicing.
 - To avoid unintentional starting of motor, never carry plugged-in tool with finger on switch and be sure switch is off when plugging in the tool.
5. Maintain tool with care. Do not use tool if switch does not turn it on and off.
 - Keep tool clean for better and safer performance.
 - Inspect extension cord periodically and replace if damaged.



1. Connect tool to power source.
2. Drop screws* point down into funnel, until tube is full with screws.

* *Use Buildex AutoTeks® Fasteners ONLY*

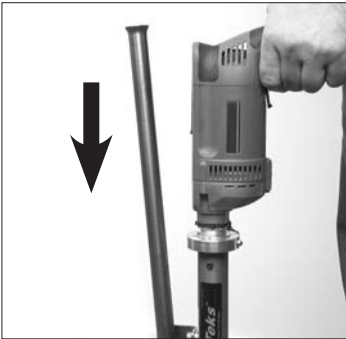

3. Push tool downward until it contacts the roof panel.
4. Engage trigger and continue to push tool downward until screw is fastened.



5. Depth Adjustment

Adjustment is made using the large ring located on the upper tool assembly. Rotating the ring closer to the screwgun will make the screw seat tighter to the roof panel.



Metal Roof Fastening System

Only the specially designed Buildex Autoteks® Fasteners can be used with the Autoteks® Multi Feed Tool Assembly.

They can however, also be used with standard drill guns.

M5.5 x 50mm

For fastening square-rib roofing profiles to steel purlins up to 4.5mm thick. 50mm in length to accommodate thicker insulation blanket.



M6 x 50mm AutoZips®

A Buildex RoofZips® screw with an Autoteks® Head!

For fastening corrugated roofing profiles to timber, thin metal battens and steel purlins up to 1.9mm thick, & square rib roofing profiles to thin metal battens.

50mm in length to accommodate thicker insulation blanket.



M6.5 x 50mm

For fastening square-rib roofing profiles to steel purlins in high wind and cyclonic regions. 50mm in length to accommodate thicker insulation blanket



DANGER:

Springs are under extreme pressure. Use care during dismantling and reassembly of the tool.



REMOVING FEED TUBE

1. Loosen wing nut.
(Do not remove)



2. Swing Feed Tube away from body of tool.

Lower Catch will disengage and tube will separate from nosepiece.



REMOVING NOSEPIECE

3. Loosen nosepiece retaining pin with hex key
4. Slide out nosepiece assembly.

REASSEMBLY OF FRONT SECTION

DANGER:

Springs are under extreme pressure. Use care during dismantling and reassembly of the tool.



CLEARING JAMMED FASTENERS

1. Pull back lower tube assembly until fastener is pushed through lower tube.

While holding the lower tube assembly slowly release the pressure until the tool springs back to position.

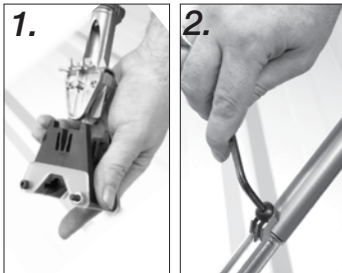

ATTACHING NOSEPIECE

1. Slide the nosepiece assembly into the lower tube assembly with retaining pin hole facing retaining pin.
2. Tighten nosepiece retaining pin with hex key.

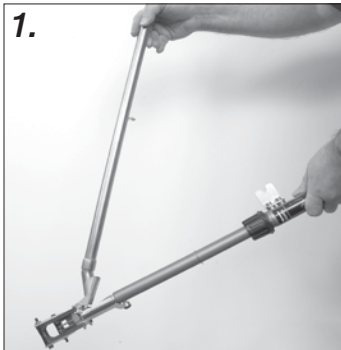

ATTACHING FEED TUBE

1. Align lower end of the feed tube so that the "ears" engage into the notches on the lower tube assembly.

Swing feed tube towards the body of the tool.



2. Tighten the wing nut.

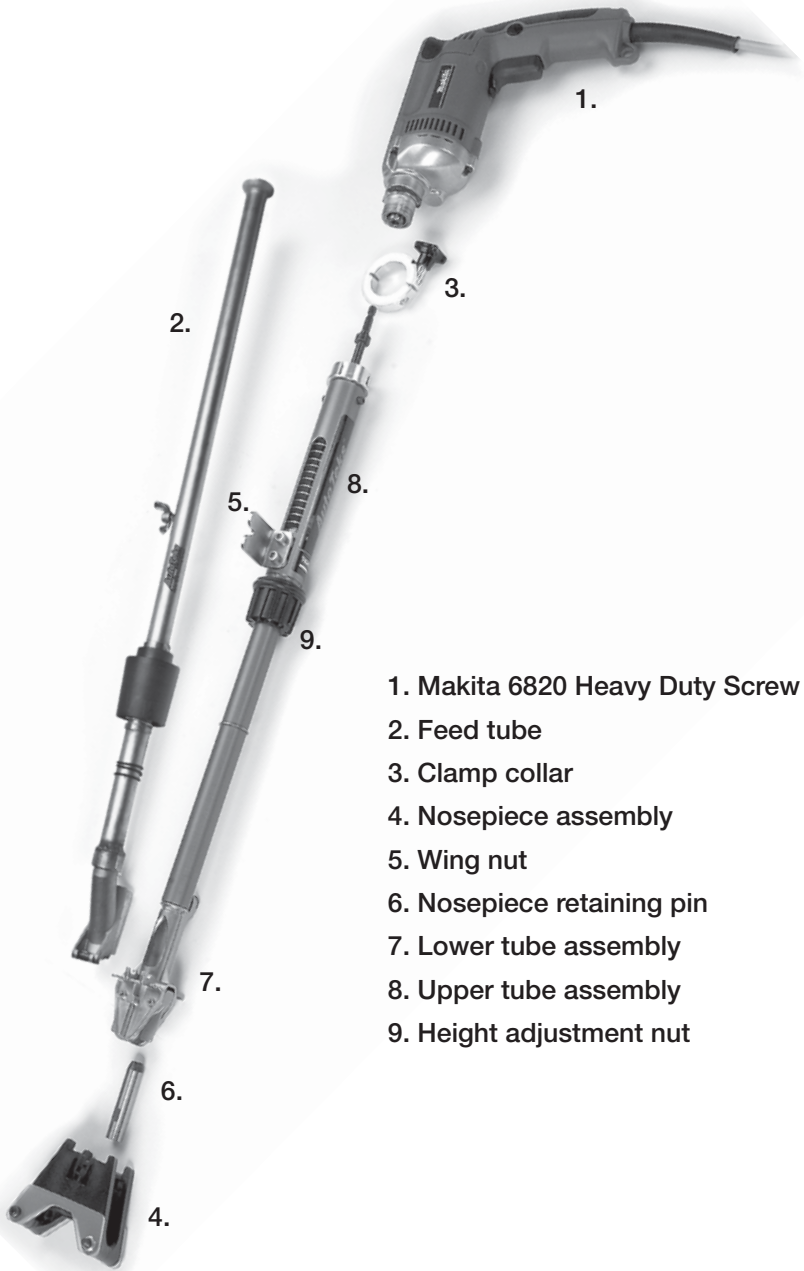

- 1. Makita 6820 Heavy Duty Screw Gun
- 2. Feed tube
- 3. Clamp collar
- 4. Nosepiece assembly
- 5. Wing nut
- 6. Nosepiece retaining pin
- 7. Lower tube assembly
- 8. Upper tube assembly
- 9. Height adjustment nut

TROUBLESHOOTING GUIDELINES

<i>DIFFICULTY</i>	<i>PROBABLE CAUSE</i>	<i>REMEDY</i>
Ratcheting noise and screws won't drill or screws kicking out during installation.	<p>Screw jammed in tool.</p> <p>Screw in upside down.</p> <p>Tool pushed down too hard.</p>	<p>Cock lower tube Open and clear feed tube.</p> <p>Drop screw point first in feed tube.</p> <p>Apply even pressure during installation. Let screw begin drilling before adding more pressure.</p>
Screw doesn't seat against roof panel.	<p>Improper depth adjustment.</p> <p>Socket may be worn out.</p>	<p>Rotate depth adjustment ring until fastener seats properly.</p> <p>Check socket. Replace if necessary.</p>
Screws stripout.	Improper depth adjustment.	Rotate depth adjustment ring until fastener seats properly.
Screwgun loosens from tool.	May happen after extended use.	Tighten mounting collar assembly with channel locks and vice-grips.

3 MONTH WARRANTY*

*Buildex guarantees that this product will be free from defects in workmanship and materials for a period of 3 months from the date of purchase of the product by the customer. If a defect in material or workmanship becomes evident during that period Buildex will, at its option, either:

- repair the product (or pay for the costs of repair of the product); or
- replace the product.

In the event of such a defect, the product should be returned to the place of purchase, together with proof of purchase for repair or replacement. Any handling and transportation (and other expenses incurred in claiming under this warranty) are not covered by this warranty and will not be borne by Buildex. To the extent permitted by law, except as expressly provided in this warranty, Buildex shall not be liable for any injury, loss or damage, direct, indirect, incidental or consequential, arising out of the use of, or the inability to use, this Buildex product. The obligation of Buildex under this warranty is limited to the circumstances set out above and is subject to:

- the customer being able to evidence the acquisition of the product, the purchase price paid for the product and the relevant defect in materials or workmanship;
- the product not having been altered, tampered with or otherwise dealt with by any person in a manner other than as intended in respect of the relevant product; and
- the product not having been used or applied in a manner that is contrary to customary usage or application for the relevant product or contrary to any stated instructions or specification of Buildex.

Our goods come with guarantees that cannot be excluded under the Australian Consumer Law. You are entitled to a replacement or refund for a major failure and for compensation for any other reasonably foreseeable loss or damage. You are also entitled to have the goods repaired or replaced if the goods fail to be of acceptable quality and the failure does not amount to a major failure. The benefits given by this warranty are in addition to other rights and remedies which may be available to the customer under any law in relation to goods or services to which this warranty relates.

Buildex, a division of ITW Australia Pty Ltd (ACN 004 235 063)
600 South Road
Moorabbin, Victoria, 3189
Australia
Ph: 03 9555 6433
Email: marketing@buildex.com.au

AutoTek[®]

MULTI FEED 

Metal Roof Fastening System

Buildex[®]

A.C.N. 004 235 063 008
A.B.N. 63 004 235 063 008

600 South Road (PO Box 1154)
Moorabbin Vic 3189 Australia
Phone : (03) 9555 6433



Visit us at
WWW.
buildex
.com.au



For Sales Orders only:
Phone : 1300 368 101
Fax : 1800 456 448

Technical Help Desk:
Phone : 1300 137 273
Fax : 1800 137 272
Email: technicalhelpdesk@buildex.com.au



90 YEARS MANUFACTURING
IN AUSTRALIA

Teks, HiGrip, ShankGuard, and Climaseal are registered Buildex[®] Trademarks.

*Whilst every care was taken in preparation of this guide, Buildex[®] accepts no responsibility for the accuracy of the information supplied.
Copyright © 2010.*

The contents of this brochure are the exclusive copyright of Buildex[®] and may not be reproduced without written permission.