

Product Technical Data Sheet

14-10 x 68mm and 78mm Hex Washer Tek®

Part Number	Description	Pack Qty	Pallet Qty
6-311-3149-5C4	14-10 x 68mm Hex Washer Tek®, Climaseal® 4	1000	60,000
6-311-3322-2C4	14-10 x 78mm Hex Washer Tek®, Climaseal® 4	500	42,000
6-310-3124-9C4	14-10 x 68mm Hex Washer Tek® with EDPM Seal, Climaseal® 4	1000	60,000
6-310-3322-3C4	14-10 x 78mm Hex Washer Tek® with EDPM Seal, Climaseal® 4	500	42,000
6-310-3108-2C4	14-10 x 68mm Hex Washer Tek® with KlipLok Plate, Climaseal® 4	250	26,250
6-310-3351-2C4	14-10 x 78mm Hex Washer Tek® with KlipLok Plate, Climaseal® 4	200	16,800
6-310-3167-1C4	14-10 x 68mm Hex Washer Tek® with MultiSeal, Climaseal® 4	250	26,250
6-310-3341-8C4	14-10 x 78mm Hex Washer Tek® with MultiSeal, Climaseal® 4	250	26,250

Application:

Buildex® 14-10 x 68 and 78 mm Hex Washer Tek® Screw is used for crest fixing Roof Sheets to steel purlins. The product is available with an EDPM Seal, Multi Seal assembly, Corn-Lok® and Square-Lok®, Cyclone assemblies.

Drill Capacity:

Steel 1,2 mm ~ 2,4 x 2

Features:

Hex Drive
Tek® Point
Finish

Benefits:

For positive drive under high installation torque
For drilling into steel while ensuring maximum pullout strength and a high strip torque.
Corrosion performance Climaseal® 4

Installation Instructions:

1. Use a Buildex® 3/8 Hex Head Driver Bit (1-991-1370-4)
2. Use a mains powered or cordless screw driver with a 2,500 RPM speed.
3. Fit the 3/8 driver bit into the screw and place at the fastening position.
4. Apply consistently firm pressure (end load) to the screw driver until the screw has fastened.

Material: Carbon Steel SAE 1022 **Heat Treatment:** To AS 3566.1 | **Finish:** Climaseal® 4

Mechanical Properties:

Single Shear Strength (N) 10,900 | Axial Tensile (N) 19,700 | Torsion Strength 18,50 N-m

Pullout Values (N):

Steel Purlin 1.2: 2,600 | Steel Purlin 1.5: 4,680 | Steel Purlin 1.9: 6,500 | Steel Purlin 2.4: 8,100

All values are averages obtained under laboratory conditions and appropriate safety factors should be applied for design purposes. These figures are applicable to Buildex® head marked product only.

Corrosion Performance:

Buildex® 14-10 x 68 and 78 mm Hex Washer Tek® comply to Australian Standards AS3566.2 Class 4

Product Technical Data Sheet

14-10 x 68mm and 78mm Hex Washer Tek®

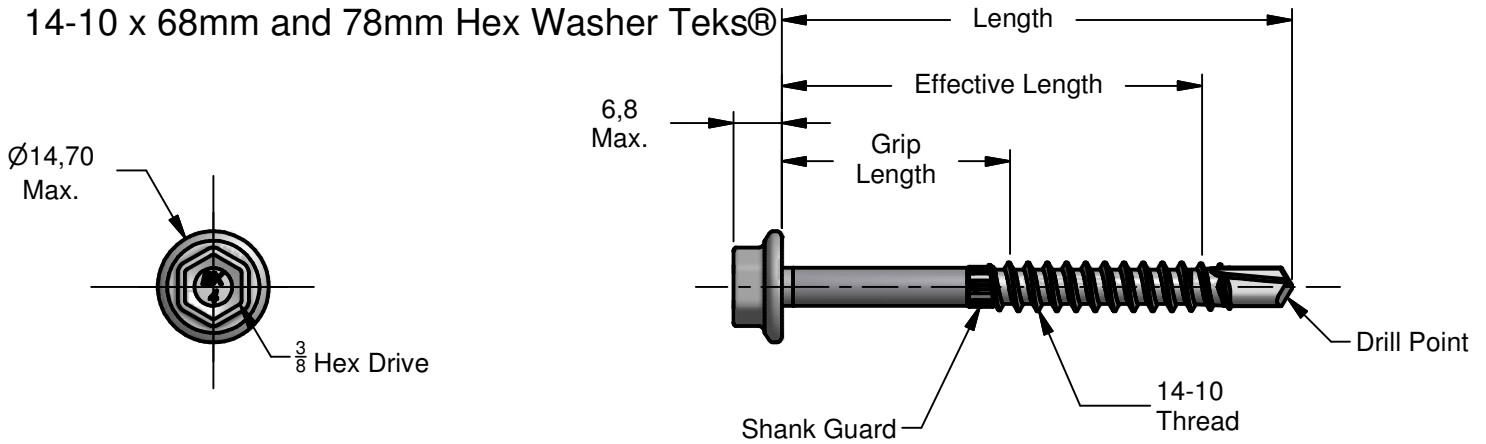

Part Number	Description	Length	Grip Length	Effective Length
6-311-3149-5C4	14-10 x 68 Hex Washer Tek®	66.0 / 67.5	29.5 / 31.5	50.0 Min.
6-311-3322-2C4	14-10 x 78 Hex Washer Tek®	76.0 / 77.5	39.5 / 41.5	60.0 Min.

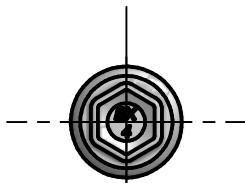

Part Number	Description
6-310-3124-9C4	14-10 x 68 Hex Washer Tek® with EDPM Seal
6-310-3322-3C4	14-10 x 78 Hex Washer Tek® with EDPM Seal

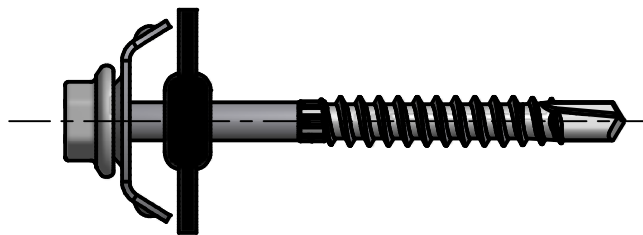
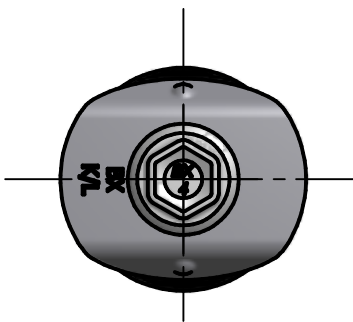

For High Rib Profiles in Cyclone Areas

Part Number	Description
6-310-3108-2C4	14-10 x 68 Hex Washer Tek® with KlipLok® Plate
6-310-3351-2C4	14-10 x 78 Hex Washer Tek® with KlipLok® Plate

All dimensions nominal unless otherwise stated. Normal manufacturing tolerances apply.

Product Technical Data Sheet

14-10 x 68mm and 78mm Hex Washer Tek®

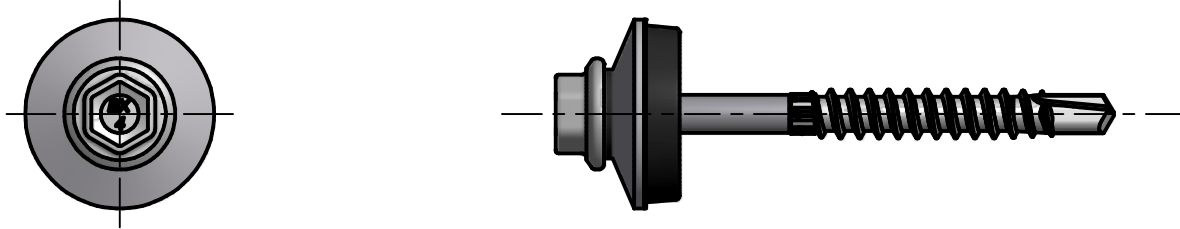

For Ridge Cap Fixing in Cyclone Areas

Part Number	Description
6-310-3167-1C4	14-10 x 68 Hex Washer Tek® with MultiSeal
6-310-3341-8C4	14-10 x 78 Hex Washer Tek® with MultiSeal

All dimensions nominal unless otherwise stated. Normal manufacturing tolerances apply.

Buildex® Head Office
600 South Road
Moorabbin Victoria 3189
Australia
1300 368 101

CustomerService-MBN@buildex.com.au

Buildex® Middle Eastern Sales Office
middleeastsales@buildex.com.au

Technical Help Desk
Technicalhelpdesk@buildex.com.au